

ECOROLL



MATERIAL

Ecoroll is obtained from the agglomeration of vulcanised rubber micro-granules (density 720 kg/m³). It is an ecological material composed of recycled raw materials and so it is 100% recyclable. Ecoroll has a great sound and thermal insulating power, thanks to its elasticity it is a very good vibration damper and it also has a very high resistance to rending, tearing, compression and abrasion.

STANDARD SIZE:

Rolls width 1250 mm
Thickness 3 mm,
length 20 m.
Thickness 5 mm,
length 12 m.

Other thicknesses and dimensions on request.

Size Tolerance to DIN 7715 standard, part 2.

SOUND-INSULATING AND
ECOLOGICAL ROLL FOR
ANY KIND OF FOOTFALL
NOISES

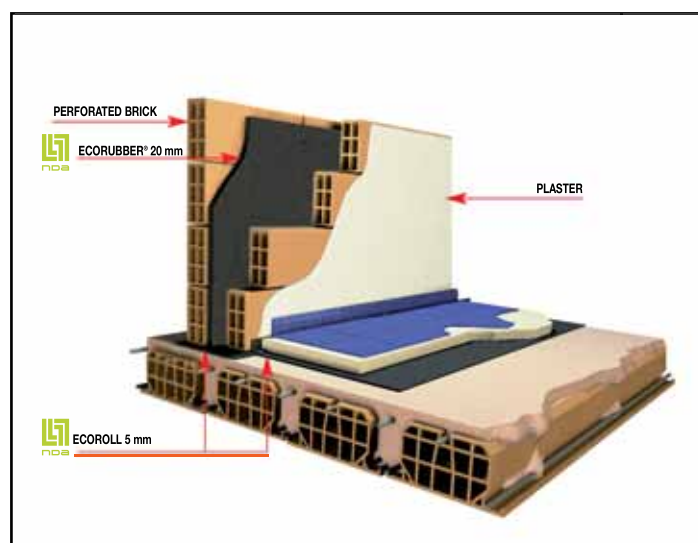

FIELDS OF APPLICATION:

Ecoroll is widely used under the flooring in order to improve footfall sound-proofing. It can be installed in any kind of construction (houses, offices, hospitals, trade centres, etc.) as it offers an excellent sound insulation, better than what the law provides for.

INSTALLATION

Ecoroll must be installed directly over the rough floor, its extremities must cover up the bottom of the perimeter walls and the installation must look seamless. Always use AKUSTIK BORDER perimeter band. To have a good result, we suggest to place a layer of polyethylene under the rough floor.

The installation of WALL BAND is also recommended to interrupt the acoustic bridges between the rigid structures.

Ecoroll can also be installed under the wooden floors.

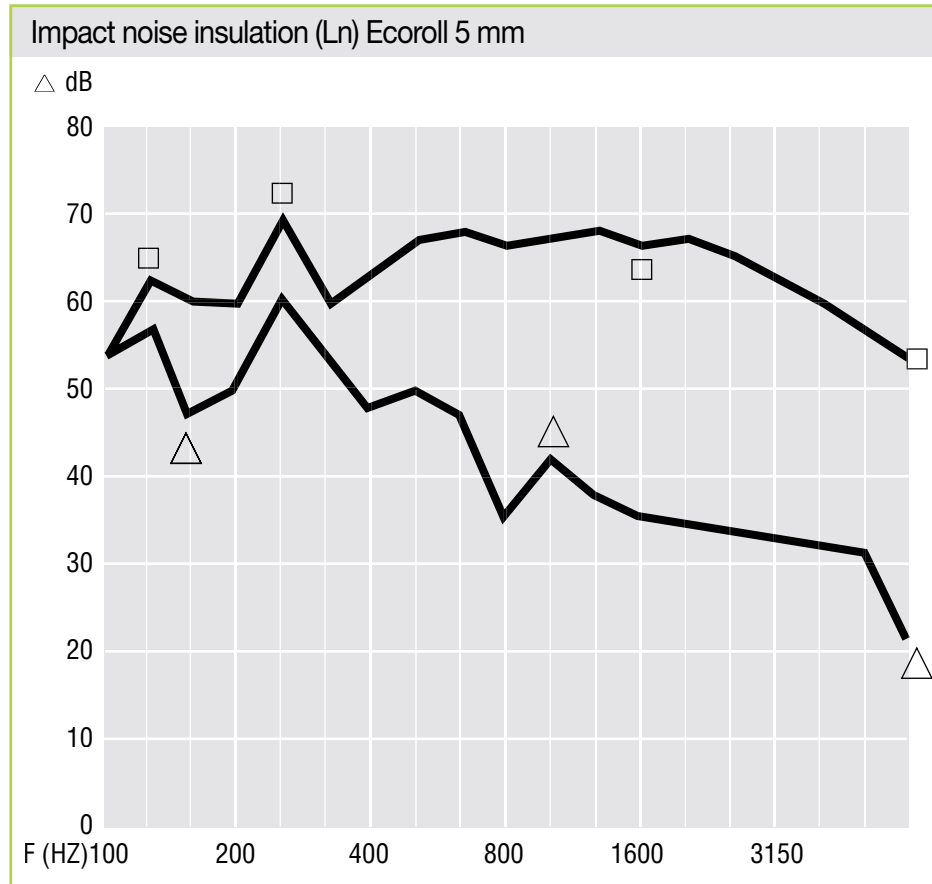

Dynamic stiffness measurement value: 55 MN/m³

Impact sound insulation of floors: △ L: 24,5 dB

Frequency	background	L1	T	Ln	Li	T	Ln
Hz	dB	dB	sec	dB	dB	sec	dB
100	18,4	57,3	1,56	54,6	57,3	1,56	54,6
125	23,6	64,0	1,38	61,8	59,2	1,38	57,0
160	13,3	64,0	2,01	60,1	51,3	2,01	47,4
200	15,2	62,4	1,44	60,0	51,5	1,44	49,1
250	11,6	70,8	1,55	68,1	63,4	1,55	60,6
315	11,7	66,8	3,13	61,0	60,0	3,13	54,2
400	8,4	67,6	1,84	64,1	50,6	1,84	47,1
500	6,9	70,0	1,53	67,3	48,3	1,53	45,6
630	5,2	70,4	1,44	67,9	51,7	1,44	49,3
800	3,0	69,5	1,29	67,5	49,3	1,29	47,4
1000	2,2	68,9	1,07	57,8	36,8	1,07	35,7
1250	2,4	69,5	1,03	68,5	42,9	1,03	41,9
1600	2,9	68,4	1,01	67,5	39,1	1,01	38,2
2000	3,5	69,0	1,10	67,8	37,3	1,1	36,0
2500	4,5	67,5	0,94	66,9	35,2	0,94	34,7
3150	5,2	64,7	0,94	64,2	34,2	0,94	33,6
4000	5,8	61,2	0,90	60,8	32,7	0,9	32,3
5000	6,5	56,3	0,80	56,5	20,8	0,8	21,0
dB(A)	17,1	78,8	1,26	76,9	59,4	1,26	57,6